



WARNING!

- 1.The toy may have potential sharp edges or sharp points or small points before assembly.Parts,therefore,must be assembled by adults.
- 2.Under the supervision and guidance of adults,use the car correctly Otherwise,it may cause injury to oneself or a third party.
- 3.Strictly prohibit dangerous places such as public streets, roads, slopes, swimming pools,etc.Driving and playing,otherwise it may cause traffic accidents and drowning hazards.
- 4.This toy car may have small parts falling off when it is used,so no. Suitable for children under 36 months.
- 5.This product is only suitable for children aged 37-96 months. Before use Please wear protective equipment,such as helmet,hand sheath,knee pads,etc.
- 6.Cars should not be overloaded.The maximum load is 30 kilograms
- 7.Chargers and batteries,wires,plugs and other components must be periodic Check whether it is damaged or not and stop using when it is found to be damaged until it is repaired.
8. Keep away from fire.
- 9.Please read the product instructions carefully before operation. This is very important and please Keep it for future reference.

Electric tricycle for children Installation and use instructions

- Early Education,
- dual-wheel drive,
- USB,
- LED headlamps,
- MIC,
- Bluetooth,

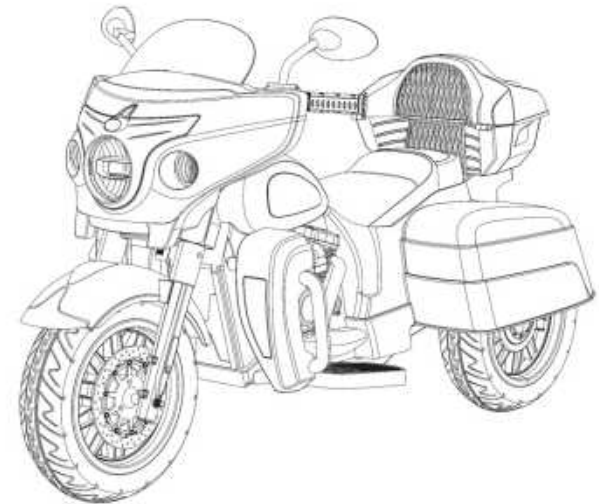

Specification parameter

Age of use:	37-96Months of child use	Battery:	12V4.5AH
Load limitation:	30kg	Outline size:	1095*475*680mm
speed:	3~5km/h	Power supply mode:	Charging type
Charger specification:	input: 220V output: DC6V0.5A/DC12V0.5A	Battery life:	Charging times are about 280
Charging time:	About 8-12 hours	Fuse:	Self-resetting fuse

Product sketch

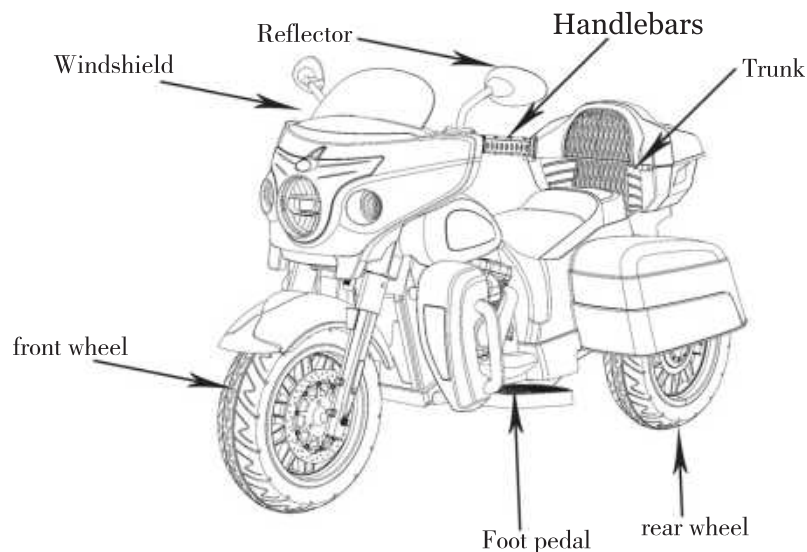

Maintenance and maintenance:

- After normal use of this product, adults should regularly (half a month is recommended) the main components of this afternoon, such as: Batteries, chargers, wires, enclosures, switches, steering systems and other components shall be inspected, and fastening components shall be exhausted. See if it is loose and stop using it until it is repaired when potential danger is found.
- Clean vehicles can be wiped with soft cloth which is slightly wet and dripless, or with non-waxy furniture polishing instead of soft cloth polishing. Material parts to achieve surface finish effect. Do not wipe the plastic parts of toys with chemical solvents. Avoid Corrosion; do not use soap and water to clean vehicles, water will damage motors, batteries, resulting in short circuit circuit circuit system.
- After using for a period of time, please lubricate the iron parts of the vehicle with lubricating oil to prevent rusting.
- Cars should be kept away from high temperature and humidity. Plastic parts can melt. When charging, keep away from inflammable goods, prevent Stop cattle fire.
- Please charge it in time after use. It must be operated by adults. If it is collected or not used for a long time, it must be filled first. Electricity is stored and recharged every month to extend battery life.
- When you stop using or place the car for a long time, please cut off the power supply of the car. All switches to "stop" Or "close" position. No unauthorized alteration of the product's structure and circuit system, maintenance and maintenance of key parts shall be allowed. Replacement should be conducted under the guidance of professionals.
- In areas where the supply voltage is unstable, it is recommended to install a power regulator to protect the battery when charging. Do not use fuses that do not conform to product specifications.

Simple maintenance:

fault type	Cause analysis	Elimination method
The car won't move.	1. Battery voltage is too low 2. Fuse protection 3. Wheel nuts fall off 4. Battery Connector Shedding 5. The battery is broken. 6. Electrical damage 7. Bad motor	1. Charging Batteries 2. Stop for a few minutes and use it 3. Re-screw the nut 4. Re-insert 5. Replace new batteries 6. Maintenance at maintenance points 7. Maintenance at maintenance points
Batteries do not charge	1. The connector on the battery is off. 2. Charger is not electrified 3. The charger is broken.	1. Re-insert 2. Re-insert 3. Replacement of chargers
Short range	1. Batteries are not charged 2. Batteries are old	1. Recharge the battery 2. Replacement of batteries
There is a slight noise and heat when charging.	1. belong to chemical reaction	normal
Slow speed	1. battery old 2. Batteries are dead 3. overload 4. Road unevenness	1. Replacement of new batteries 2. Recharge the battery 3. Reduce the load to less than 30 kg 4. Drive on flat ground
Noise in gearbox	1. The gear is broken.	1. Maintenance point maintenance
The car wobbled as it went along.	1. Poor contact of motor connection wire 2. There is a dead point on the motor.	1. Reconnect 2. Maintenance of Maintenance Points

Battery warning:

- New and old batteries can not be mixed with different types of batteries.
- It is strictly forbidden to short circuit the positive and negative poles of batteries.
- Non-rechargeable batteries cannot be recharged.
- The rechargeable battery is removed from the toy before charging.
- Batteries are put in at the correct polarity.
- Rechargeable batteries can only be charged by adults.
- The exhausted batteries should be removed from the toys and handled properly to prevent children from playing.
- When you do not use toys for a long time, please remove the batteries from the toys and place them properly.

Charge:

- Power must be turned off when charging.
- The charging seat is under the seat cushion.
- Open the protective cover on the charging hole, and the charger plug is inserted into the socket of the charger socket.
- Then insert the charger into the power outlet.

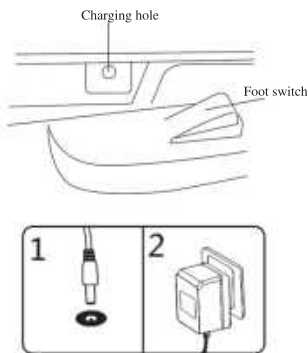

Points for Attention in Charging:

- Charging must be done by adults.
- When using an electric vehicle for the first time, the battery must be charged for 4 ~6 hours,
- Permanently damaged batteries cannot be repaired.
When charging, please turn off the power supply. First, insert the charger plug into the charging hole to charge the charger. Plug in the power socket, the whole car can not be operated when charging.
- When the power is insufficient, please charge it in time. The normal charging time is 8~12 hours, but not more than 20 hours.
- Battery heating is a normal phenomenon in the charging process, but if the temperature is too high, it is necessary to check whether the charging current is too large or whether the battery is short-circuited.
- Water in the charging socket can not be charged, otherwise it will cause short circuit.
- Only the chargers and batteries equipped with this vehicle are allowed to be used. It is strictly forbidden to use other brands of chargers and batteries. Otherwise, the chargers and battery box wiring of this vehicle may be damaged.
- If the product is collected or not used for a long time, it must be fully charged and charged once a month to ensure the battery life.
- Chargers and batteries are not toys and children are not allowed to play.

Packing Diagram

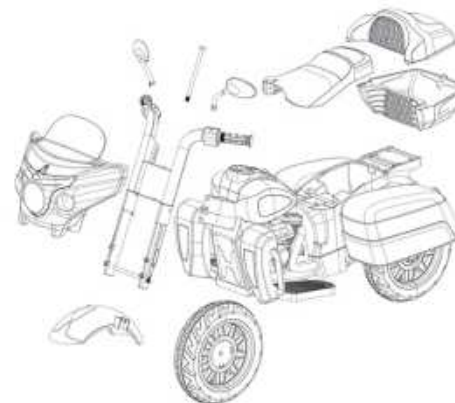

Product Specification 1,
Body 1, Saddle 1,
Charger 1,
Accessories Package 1,
Front Wheel 1, Trunk 1,
Car 1, Front Fender 1,

Usage method

("Please check that the power switch is turned on correctly first.)

Manual function: (Note: There is no high and low speed switch in single drive.)

Forward:

1. Put forward/backward switch to forward position;
2. Push the pedal switch gently and the car will move forward.

Stop it:

Lift your foot and release the "pedal barrier" and the vehicle will stop moving.

Back off:

1. Put forward/backward switch to backward position.
2. Push the pedal switch gently and the car will move backwards.

Warning!

When shifting gears, make sure that the vehicle has stopped completely to avoid damage to gearboxes and motors.

Function description

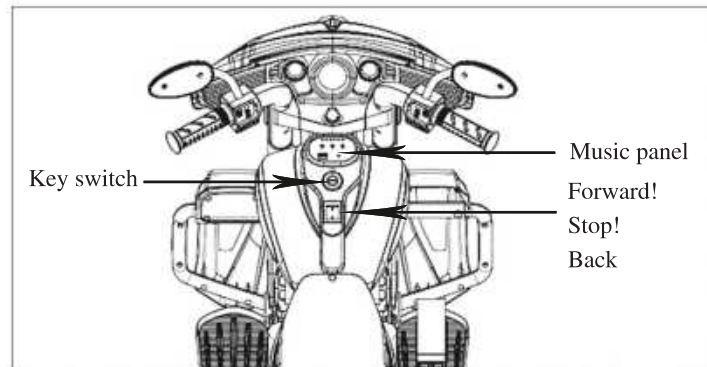

Install the reflector and the front clay tile

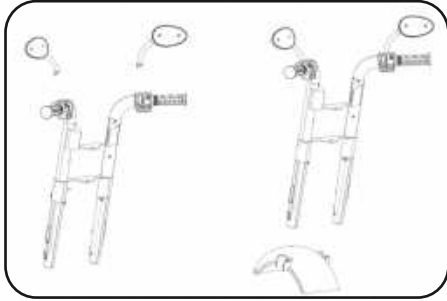

Install the reflector on the handlebar, then fix the front clay tile in the front fork by self-tapping, as shown in figure

Install the front wheel



Put the Front Axle, front wheel, left and right connecting pieces on the front fork in turn, and then fix the left and right ends, as shown in figure

Erection head

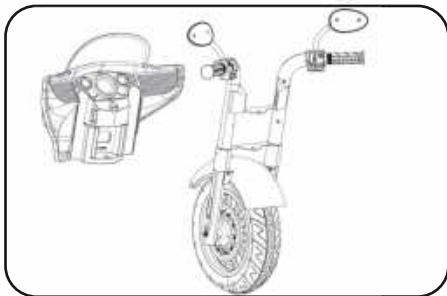

The front of the car can be stuck into the corresponding position of the handlebar, as shown in figure.

Body installation

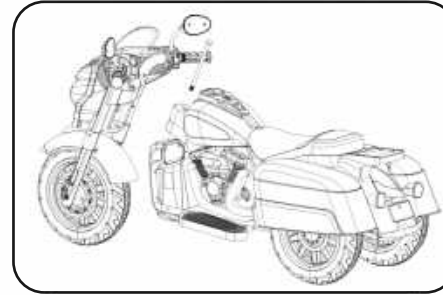

Connect and fix the front fork with the body by long screw Rod, as shown in figure

Install the trunk

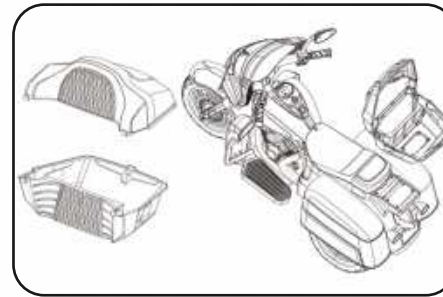

Assemble the trunk first, then attach the assembled trunk to the rear of the car with 4 screws, as shown in figure

Mounting cushion

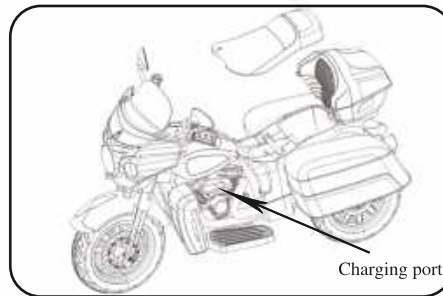

Take the seat cushion installed in a specific position on the body, screw fixed can, as shown in figure

Charging port