

TS48-60# Dresser Instructions

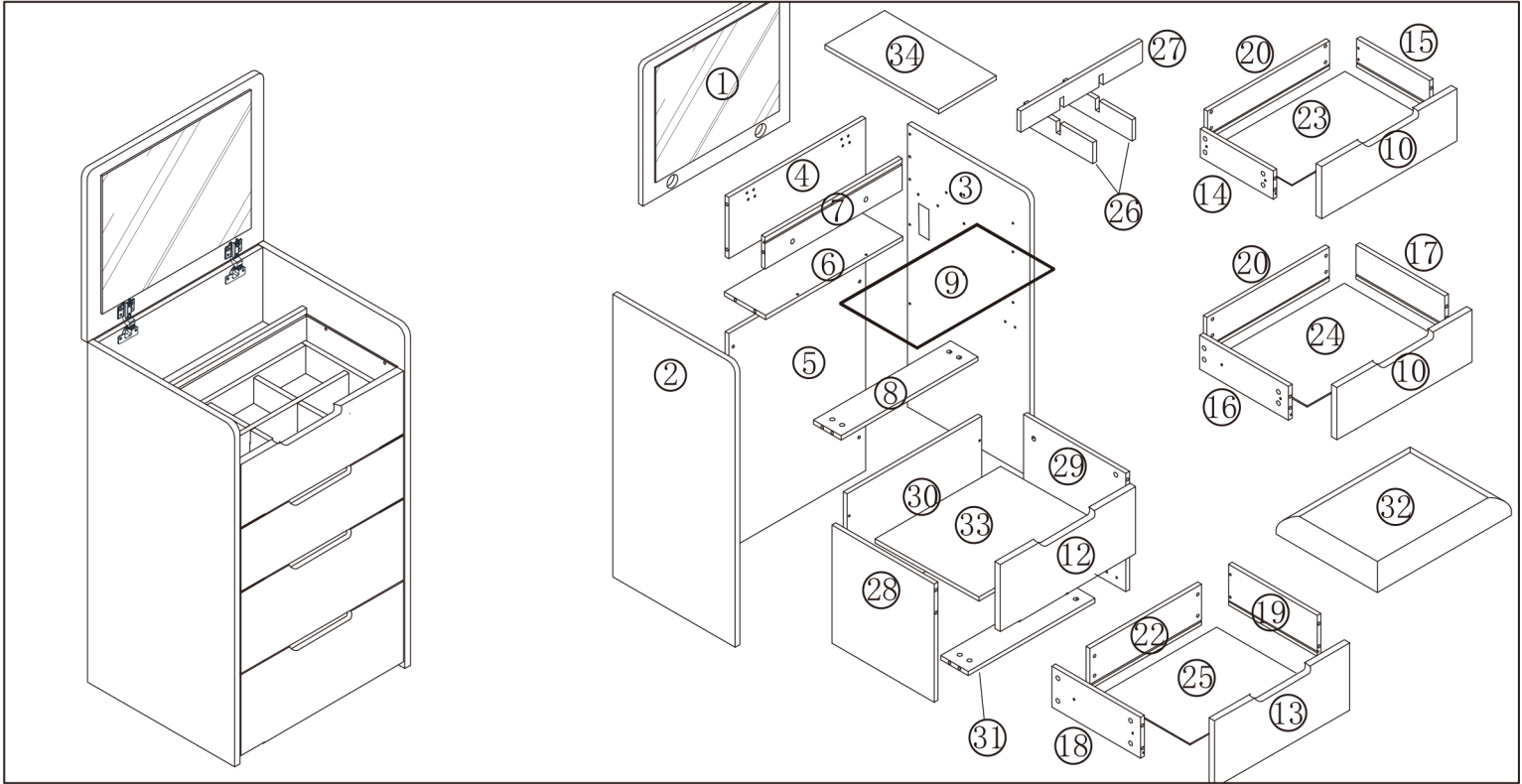

- 1 Panel 1pc

6 Laminate 1pc

11 No number

16 Middle left drawer side 1pc

21 No number

26 Lattice vertical board 2pcs

31 Stool pull 1pc
- 2 Left side panel 1pc

7 Partition 1pc

12 False drawer 1pc (wide)

17 Centre-right drawer side 1pc

22 Lower drawer 1pc (shorter)

27 Lattice panel 1pc

32 Dressing stool seat cushion 1pc
- 3 Right side panel 1pc

8 Pull Strip 1pc

13 Lower drawer 1pc(wider)

18 Large left side 1pc

23 Upper drawer bottom 1pc

28 Dressing Stool Left Side\_1pc

33 Laminate 1pc
- 4 Upper backsheet 1pc

9 Layer glass 1pc

14 Small left drawer side 1pc

19 1pc of large right side drawer

24 Middle drawer bottom 1 pc

29 Right side of dressing stool 1pc

34 Folding panel 1pc
- 5 Lower back panel 1 pc

10 Upper Drawer Side 2 pcs(narrower)

15 Small right drawer side 1 pc

20 Upper drawstring 2pcs(longer)

25 Lower drawer bottom 1 pc (shorter)

30 Make-up Stool Back 1pc

|                   | (A)      | (B)        | (C)         | (D)          | (E)           | (F)               | (H)    | (I)                 | (J)     | (K)    | (L)     |
|-------------------|----------|------------|-------------|--------------|---------------|-------------------|--------|---------------------|---------|--------|---------|
| Name (of a thing) | 3-in-1   | two-in-one | Door Hinges | Silent track | Laminate Tray | Small corner code |        | Self-tapping screws | Spike   | Socket | Bracket |
| Graphic           |          |            |             |              |               |                   |        |                     |         |        |         |
| Specifi-cation    | φ12/L=40 |            | Straight    | 10"          | φ8*18         | φ3. 5*12          | φ 4*30 |                     |         |        |         |
| Quantity          | 31 sets  | 17 pcs     | 2 pcs       | 3 pays       | 4 pcs         | 60 pcs            | 13 pcs | 2 pays              | 10 pays | 1 pays | 2 pays  |

3-in-1 instructions for use

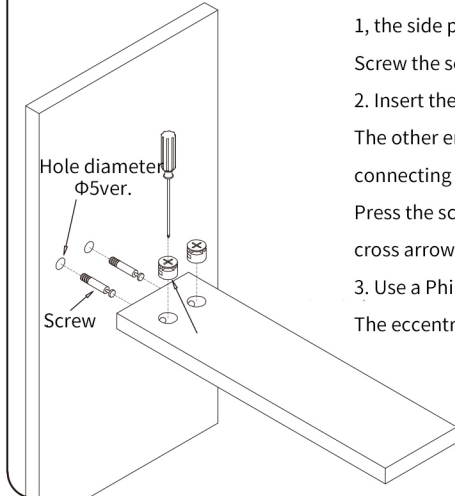

- 1, the side plate hole is diameter @5, screw the screw directly  
Screw the screw directly into this hole;
2. Insert the other end of the screw into another piece of connecting  
The other end of the screw is inserted into the side hole of the other connecting plate piece, and the eccentric lock cake is  
Press the screw into the hole with diameter @12, and note that the cross arrow corresponds to the side hole.The cross arrow corresponds to the side hole;
3. Use a Phillips screwdriver to tighten the eccentric locking cake clockwise.  
The eccentric locking cake can be tightened clockwise with a Phillips screwdriver.

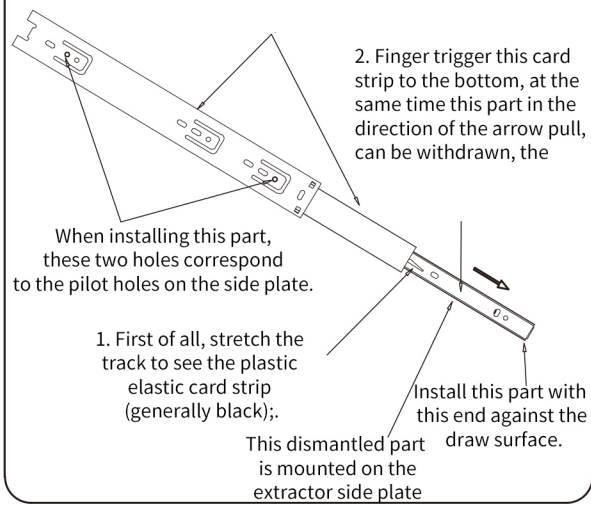

Instructions for use of 2-in-1

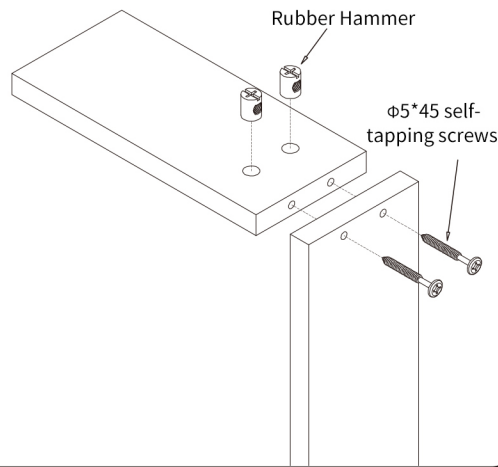

Installation steps

Step 2: Install the pull-tabs, lower back panel and left and right side panels

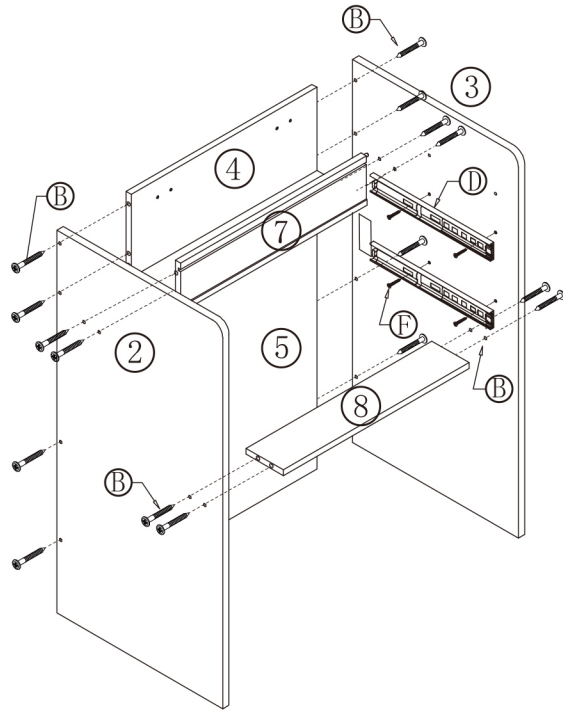
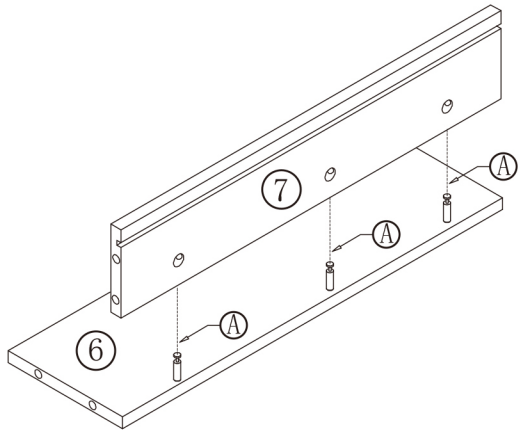

Note: The side plate is pre-installed with φ3.5\*12 screws according to the lead hole.

Step 3: Nail the foot nail first, then install the panel

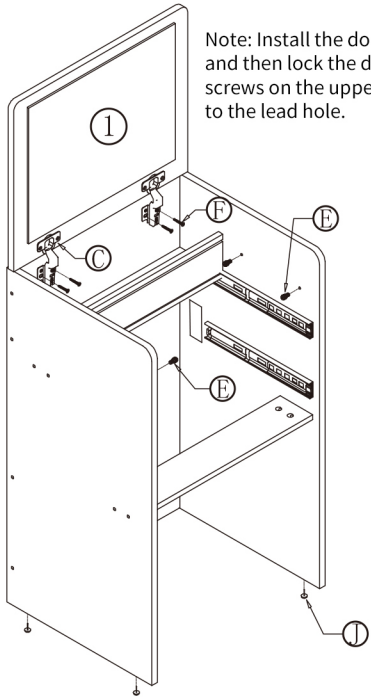

Note: Install the door hinge on the panel first, and then lock the door hinge with  $\Phi 3.5 \times 14$  screws on the upper back plate according to the lead hole.

Step 4: Assemble the side panels of the makeup stool and the pull bar according to the picture.

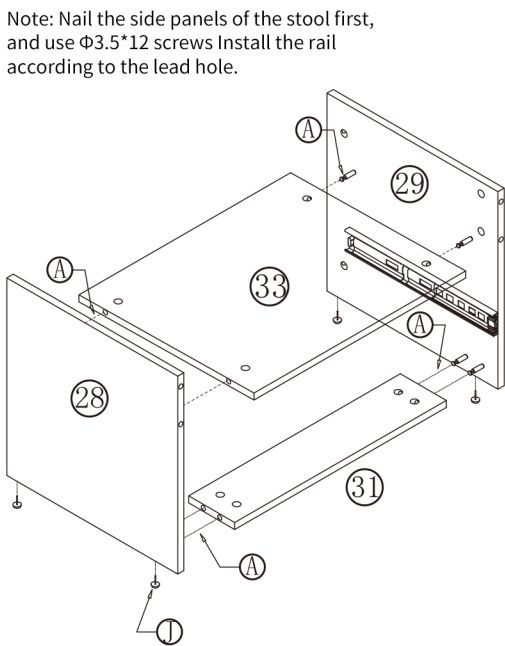

Note: Nail the side panels of the stool first, and use  $\Phi 3.5 \times 12$  screws. Install the rail according to the lead hole.

Step 9: Install the socket

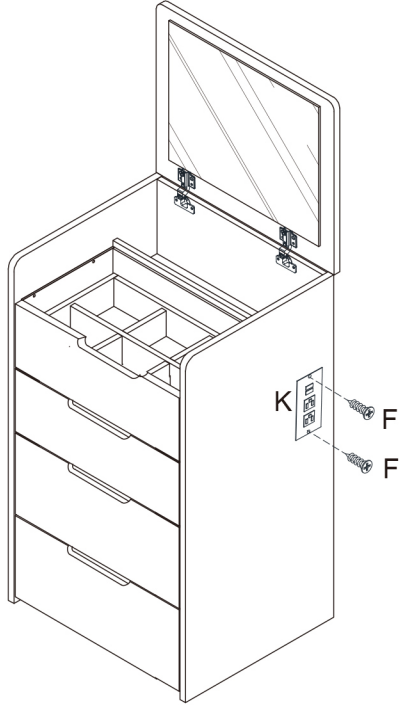

Step 10: Install panel brackets

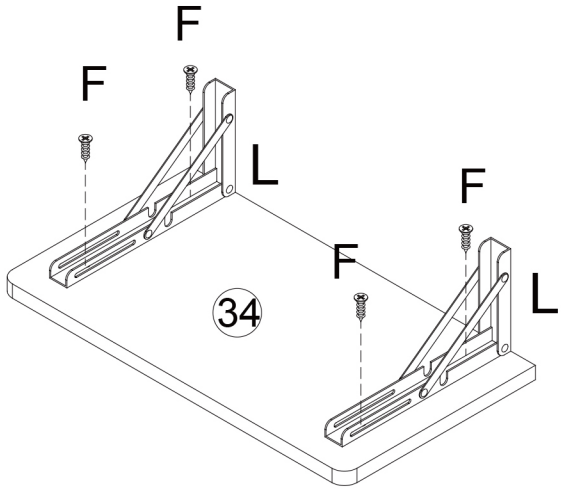

Step 5: Install the back of the makeup stool and false drawer surface

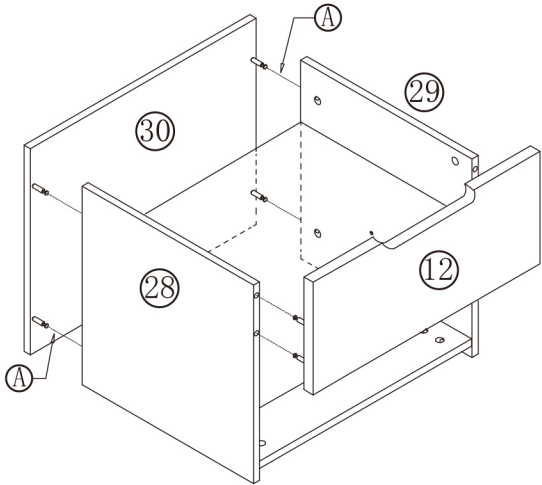

Step 6: Install the seat cushion

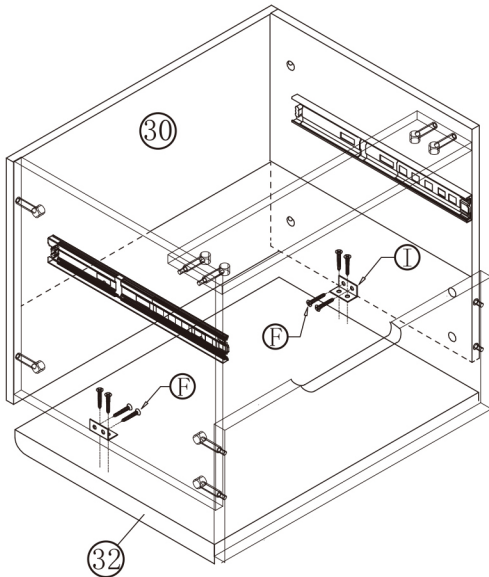

Note: Place the seat cushion in the right position, put the makeup stool upside down, and fix it with screws and small anglecode to secure it to the side panel position:

Step 11: Install Folding Panels

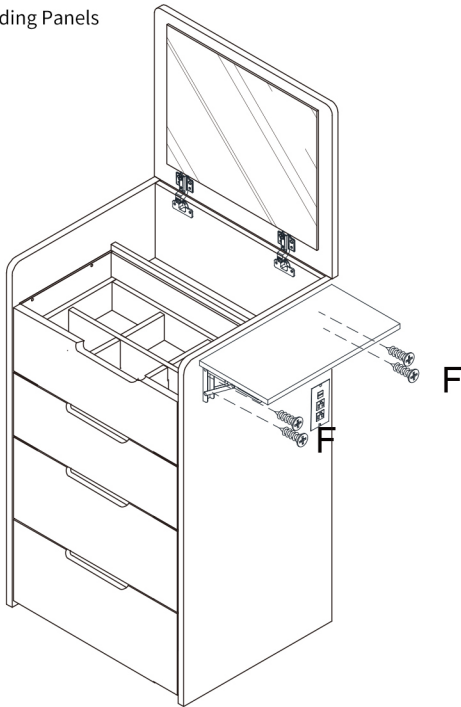

Step 7: Assemble the fart drawer as shown

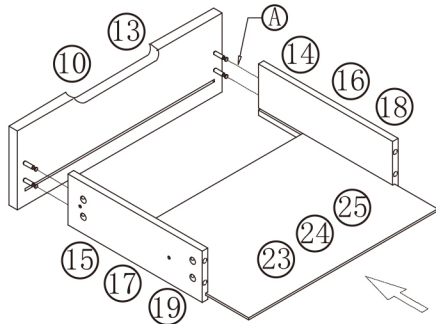

Note: Wider pumping surface for makeup deaf pumping exhibition

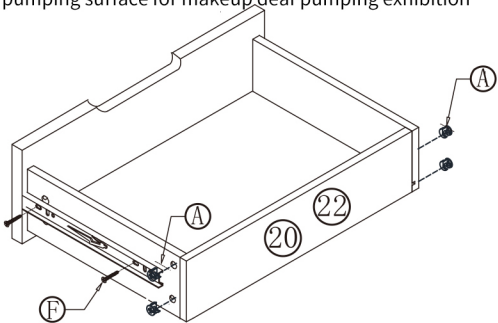

Step 8: Installation of laminated glass and drawers

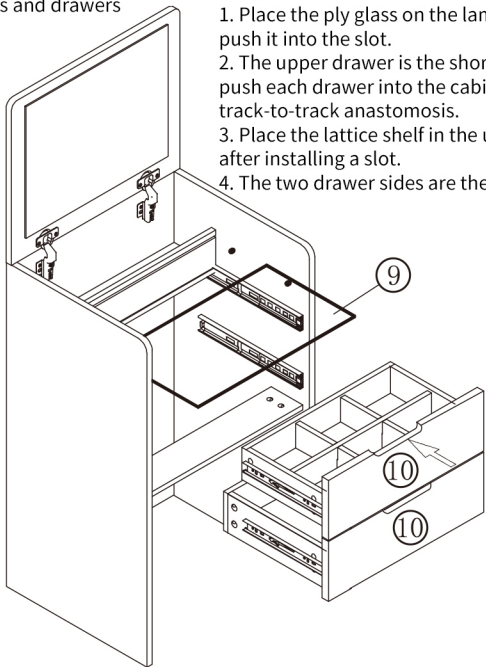

Note:  
1. Place the ply glass on the laminate tray and push it into the slot.  
2. The upper drawer is the short drawer side, push each drawer into the cabinet after the track-to-track anastomosis.  
3. Place the lattice shelf in the upper drawer after installing a slot.  
4. The two drawer sides are the same.