

Stainless Steel Litter Box

User Manual



MESSAGE TO OUR VALUED CUSTOMERS

Thank you for choosing our cat litter box. We are doing our best to make life easier for you and your cats. Please read this user manual carefully before using. You are supposed to find detailed instruction about every aspect of our cat litter box.

SPECIFICATION

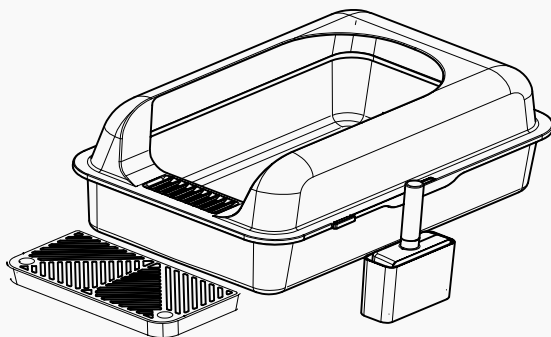

Weight: 3.5kg

Material: Stainless Steel + PP + ABS

Maximum Litter Capacity: 20 L

Litter Replacement Period: 30 days for 1 cat, 15 days for 2 cats

Optimal Amount Of Cat Litter: About 1.5" thick when spread evenly

How To Get Your Cat Used To The Litter Box Quickly

Put the cat's used litter and its excrement into the new litter box.

Let the cat have a familiar feeling of the new toilet.

WHAT'S IN THE BOX

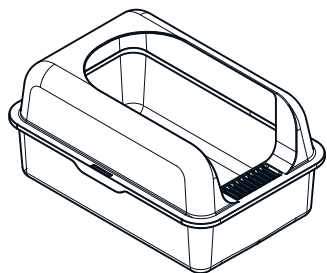

Cat Litter Box

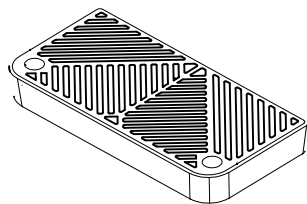

Footboard



Litter Scoop Holder



User Manual

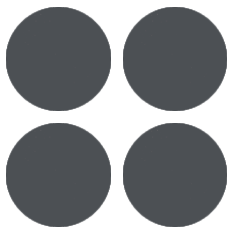

Non Slip Feet

HOW TO ASSEMBLE

HOW TO INSTALL

Method 1:

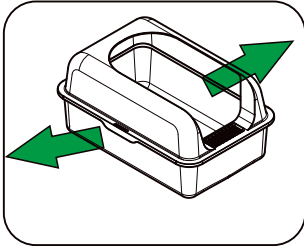

1. Place the enclosure over the metal pan and align the edge. Pull the two snaps on each side slightly to the outside.

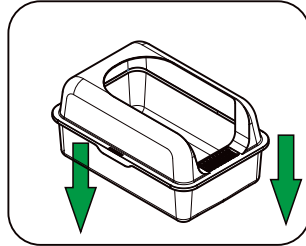

2. Press down on the snaps to complete the installation.

Method 2:

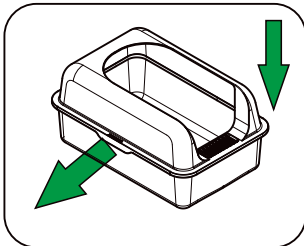

1. Place one side of the enclosure over the metal pan, pull the snap outward and press down.

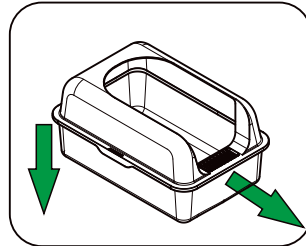

2. Then pull the snap on the other side outward and press down.

A "click" indicates that the installation is complete.

HOW TO REMOVE

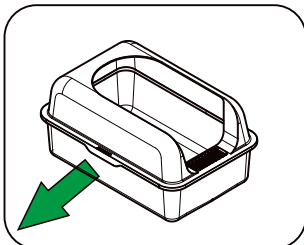

Pull the snap in the middle of the enclosure to both sides slightly, and then lift it up to take it out.

