

ASSEMBLY INSTRUCTIONS

ITEM: N852P425960W

Important note:

1. Place all wooden parts on a clean and smooth surface such as a rug or carpet to avoid scratching the parts.
2. Kindly follow the assembly instructions step by step.
3. Do not tighten all screws and bolts until the table is fully assembled.
4. Unscrew the protective plastique supports from the metal insert of the table legs before assembly.

PARTS IDENTIFICATION

A Chair Back

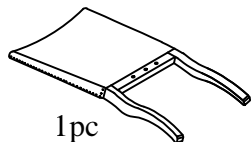

B Seat cushion

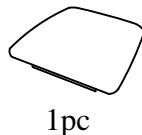

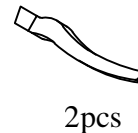

C Front Leg





HARDWARE IDENTIFICATION

1 Long Bolt
Ø1/4"X80mm
 4pcs

2 Bolt
Ø1/4"X60mm
 4pcs

3 Bolt
Ø1/4"X40mm
 2pcs

4 Spring Washer
Ø1/4"X11mm
 10 pcs

5 Flat Washer
Ø1/4"X19mm
 10 pcs

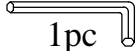
6 Allen Key
 1pc

STEP 1

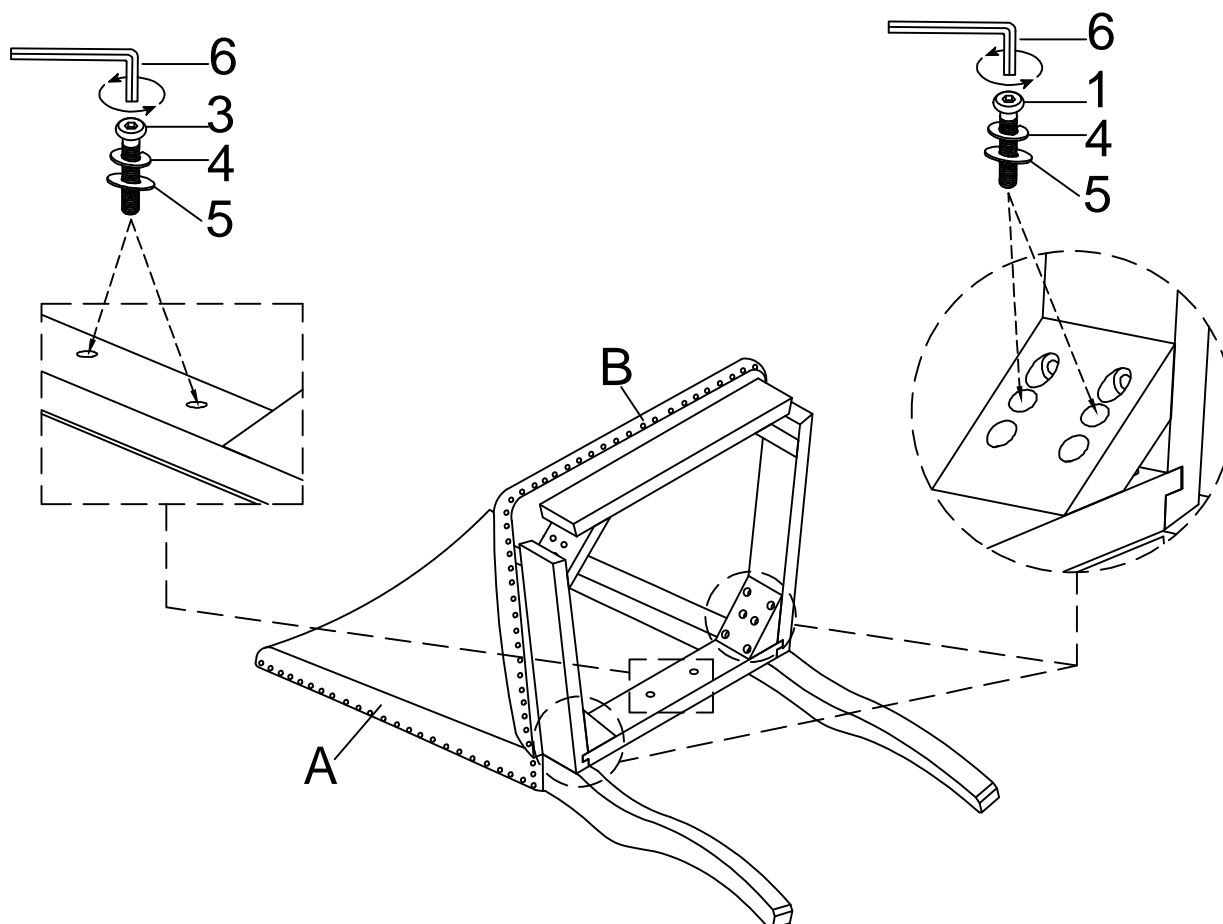

ASSEMBLY INSTRUCTIONS

ITEM: N852P425960W

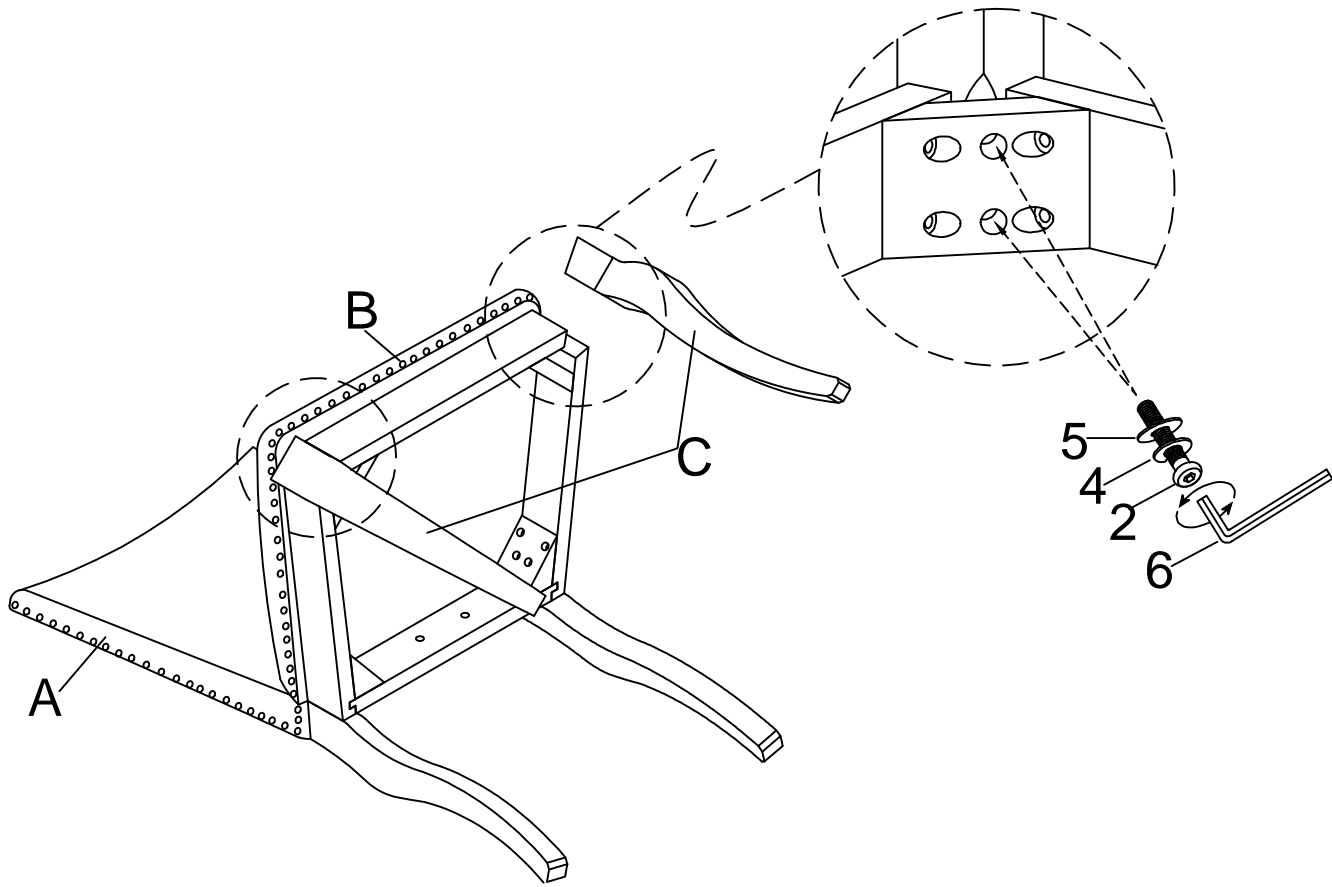

COMPLETE

